

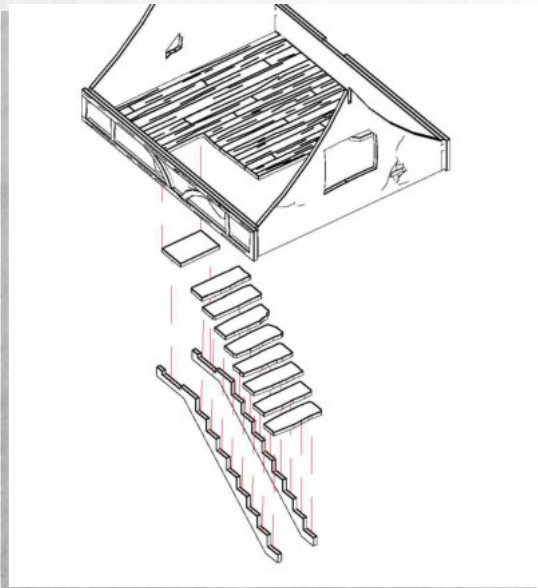

WARCRADLETM
SCENICS

Gloomburg - Blacksmiths - Assembly Guide

Parts may need careful removal from the MDF boards with a scalpel, and light sanding of any rough edges. We recommend testing assembling sections before permanently gluing together.

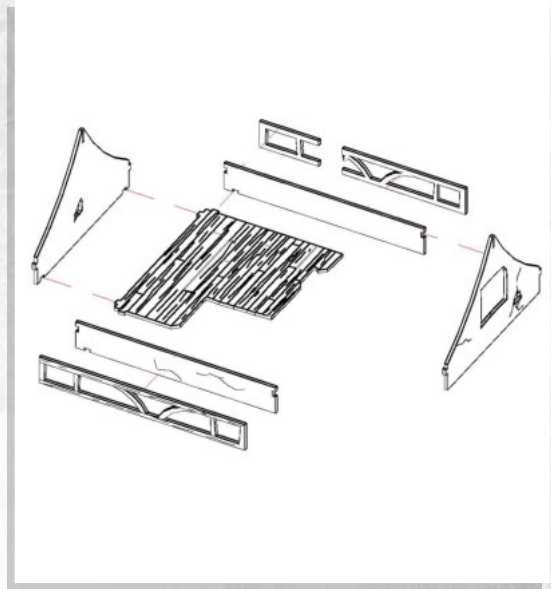
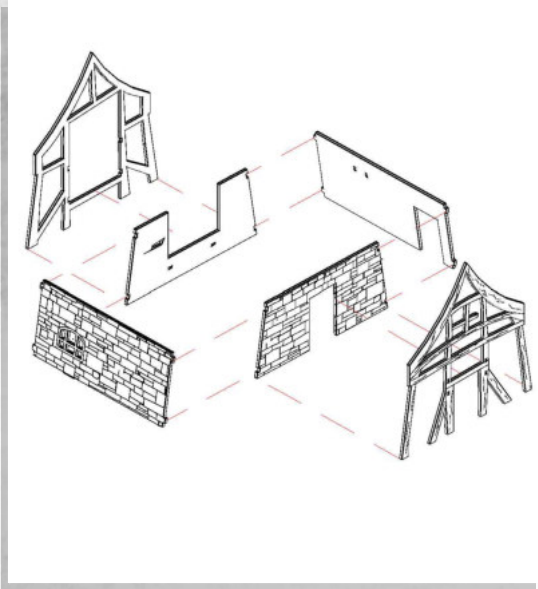

NOTE: Glue stairs to underside of floor where shown

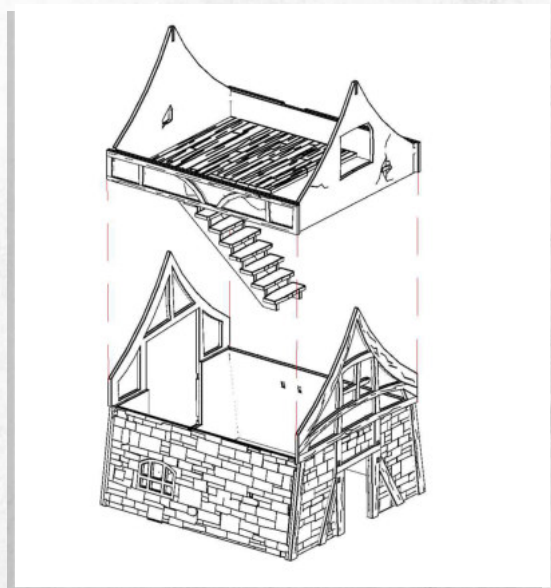

NOTE: Do not use glue when Stacking these pieces



WARCRADLETM
SCENICS

Gloomburg - Blacksmiths - Assembly Guide

Parts may need careful removal from the MDF boards with a scalpel, and light sanding of any rough edges. We recommend testing assembling sections before permanently gluing together.

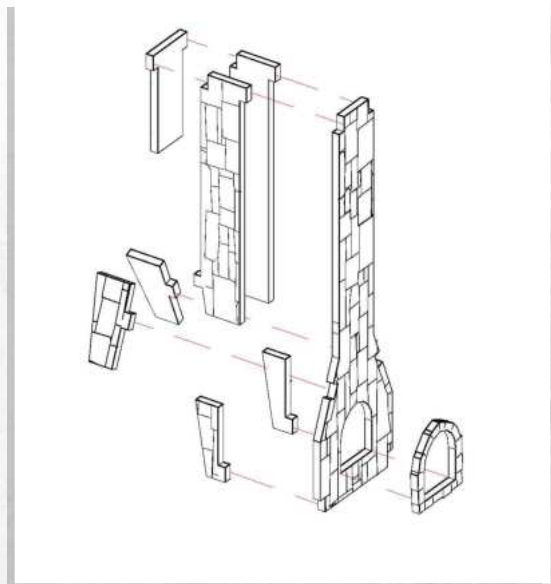
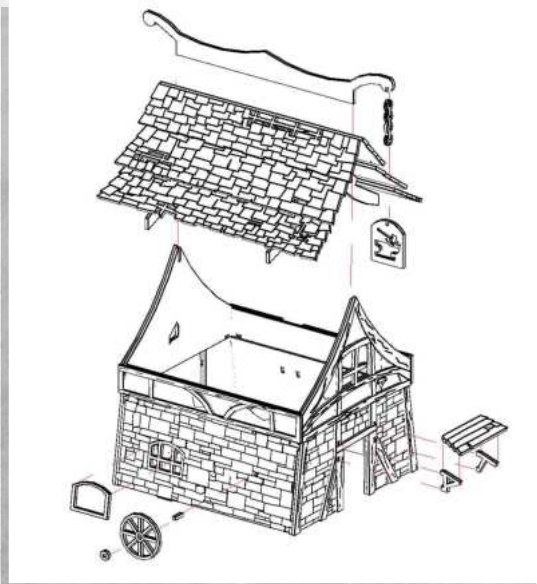
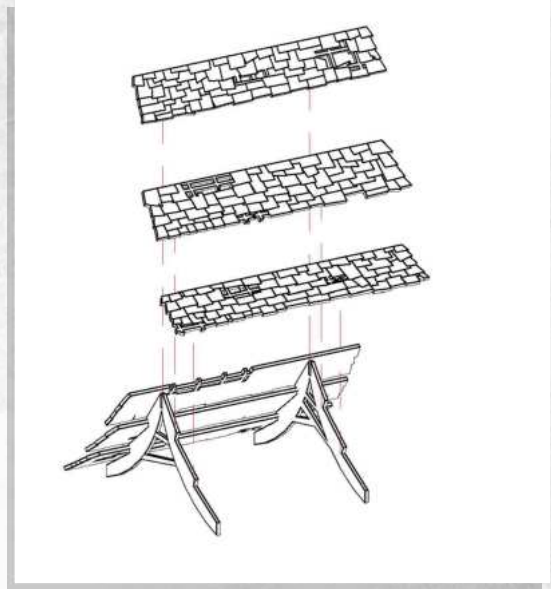
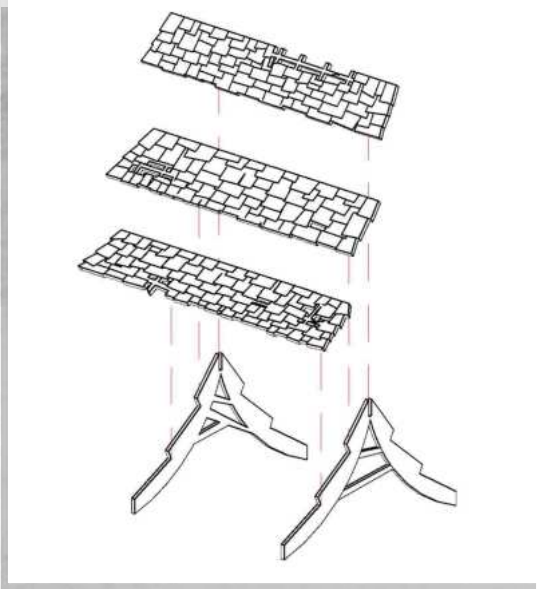

NOTE: Do not use glue when stacking the roof on the building



WARCRADLETM
SCENICS

Gloomburg - Blacksmiths - Assembly Guide

Parts may need careful removal from the MDF boards with a scalpel, and light sanding of any rough edges. We recommend testing assembling sections before permanently gluing together.

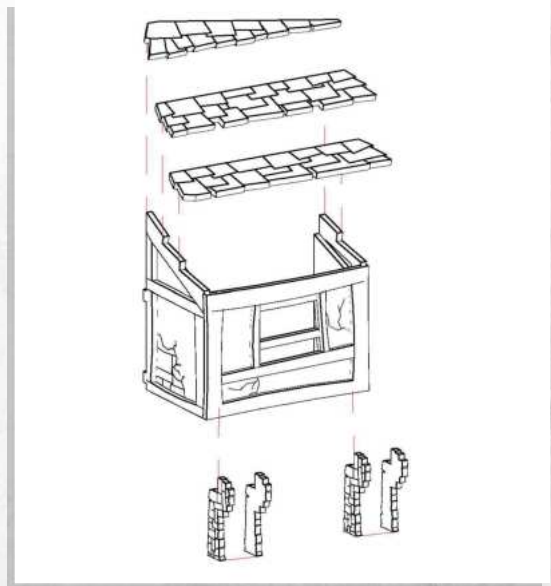
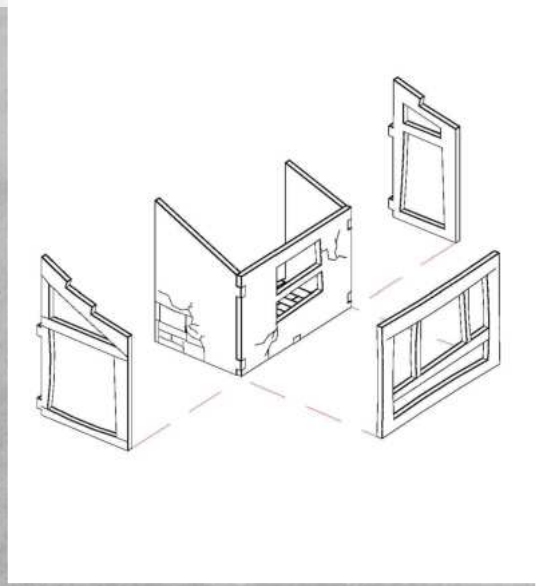
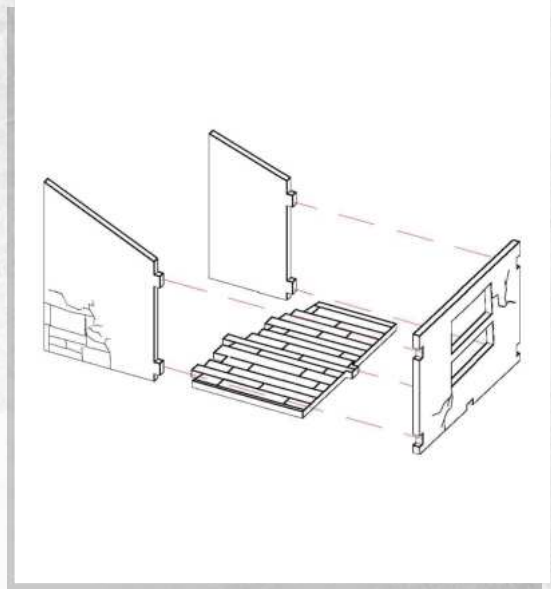
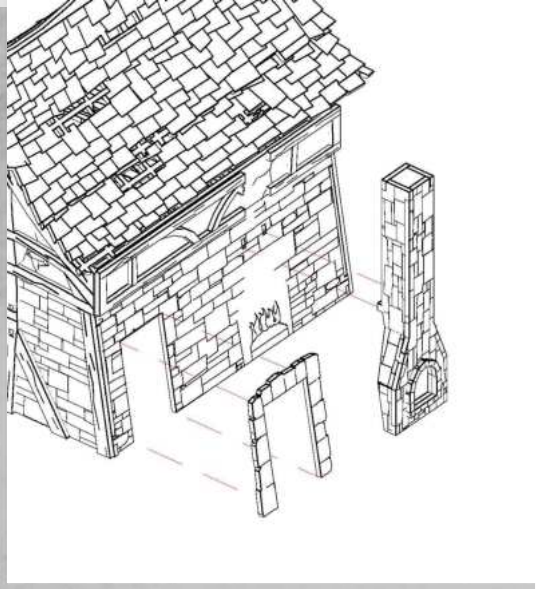



WARCRADLETM
SCENICS

Gloomburg - Blacksmiths - Assembly Guide

Parts may need careful removal from the MDF boards with a scalpel, and light sanding of any rough edges. We recommend testing assembling sections before permanently gluing together.

