



# ARCHIMEDES CLASS VAULT SHIP

LABELLED PARTS CAN BE FOUND ON THE ENLIGHTENED ADVANCED SQUADRONS SPRUES



PARTICLE  
BEAMER



10-16

PULSE  
EMITTER



17-19

STURGINIUM  
AGITATOR



39-40

\* ALL TURRETS ARE INTERCHANGEABLE

STURGINIUM AGITATOR IS AVAILABLE ON THE ENLIGHTENED SUPPORT SPRUE



# NANSEN CLASS EXPLORER

LABELLED PARTS CAN BE FOUND ON THE ENLIGHTENED ADVANCED SQUADRONS SPRUES



PARTICLE  
BEAMER



10-16

PULSE  
EMITTER



17-19

STURGINIUM  
AGITATOR



39-40

\* ALL TURRETS ARE INTERCHANGEABLE

STURGINIUM AGITATOR IS AVAILABLE ON THE ENLIGHTENED SUPPORT SPRUE



# THE SCHNEIDER

LABELLED PARTS CAN BE FOUND ON THE ENLIGHTENED FRONTLINE SQUADRONS SPRUES



DIOPHANTUS CHAOS ORB

PARTICLE  
BEAMER



\* PLACE TURRETS HERE

10-16



# KETOS OR LOTAN CLASS ASSAULT MACHINE

PARTS CAN BE FOUND ON THE ENLIGHTENED ADVANCED SQUADRONS SPRUES

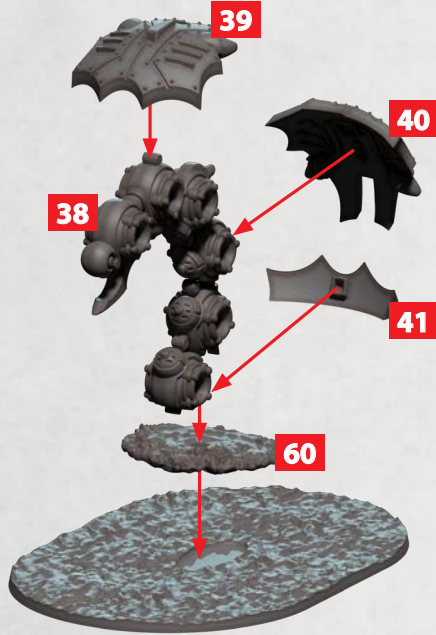

REPEAT ON THE OTHER SIDE



# KETOS CLASS ASSAULT MACHINE

PARTS CAN BE FOUND ON THE ENLIGHTENED ADVANCED SQUADRONS SPRUES



# LOTAN CLASS ASSAULT MACHINE

PARTS CAN BE FOUND ON THE ENLIGHTENED ADVANCED SQUADRONS SPRUES

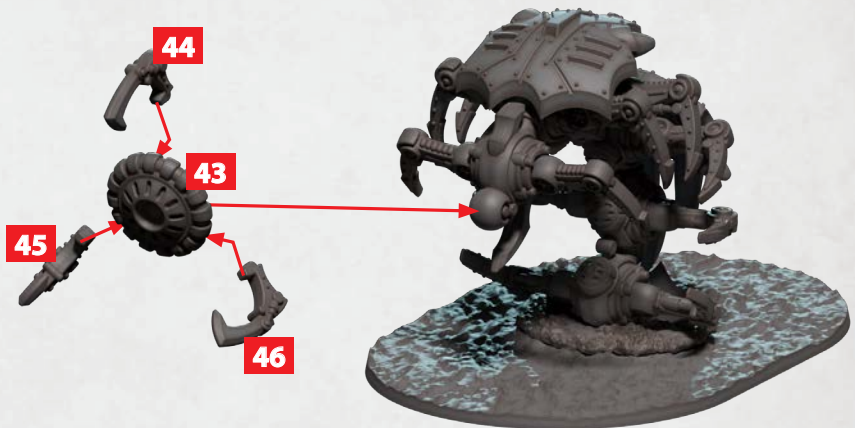



# ENLIGHTENED ESCORT

PARTS CAN BE FOUND ON THE ENLIGHTENED ADVANCED SQUADRONS SPRUES



# BRIDGE FOR NEWTON CLASS SHIP

PARTS CAN BE FOUND ON THE ENLIGHTENED ADVANCED SQUADRONS SPRUES

NOTE PARTS PLACEMENT

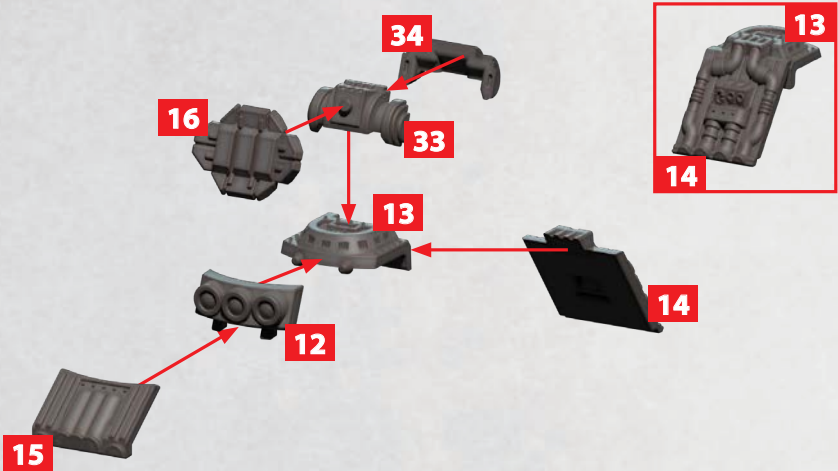



# BRIDGE FOR ZUMEENA CLASS SHIP

PARTS CAN BE FOUND ON THE ENLIGHTENED ADVANCED SQUADRONS SPRUES



# BRIDGE FOR ORIGEN OR VESALIUS CLASS SHIP

PARTS CAN BE FOUND ON THE ENLIGHTENED ADVANCED SQUADRONS SPRUES

NOTE PARTS PLACEMENT

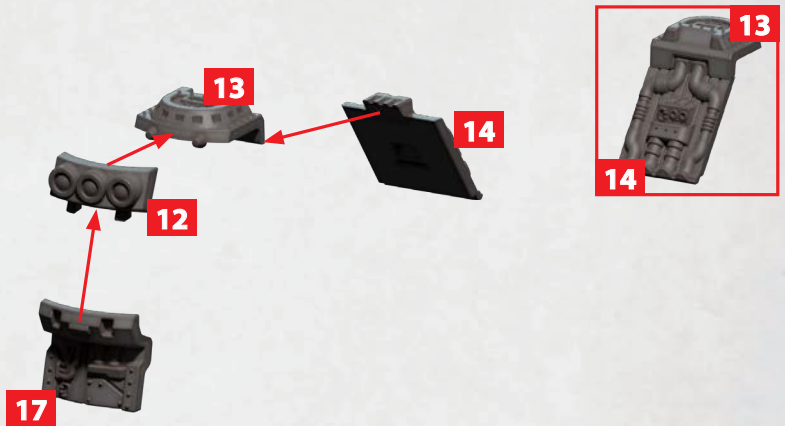



# ADVANCED CRUISER HULL

PARTS CAN BE FOUND ON THE ENLIGHTENED ADVANCED SQUADRONS SPRUES



6

**PLEASE NOTE: THE VARIOUS BRIDGE SECTION ASSEMBLED FROM PAGES 6 & 7 MUST BE ATTACHED TO THE SIDE ELEMENTS (5 & 6) THEN FIXED TO THE DECK (7) PRIOR TO ATTACHING EACH SIDES OF THE HULL (1 & 2 BELOW)**



5

SIDE A FOR ZUMEENA NEWTON AND ORIGIN CLASS SHIPS



8



7

SIDE B FOR VESALIUS CLASS SHIPS

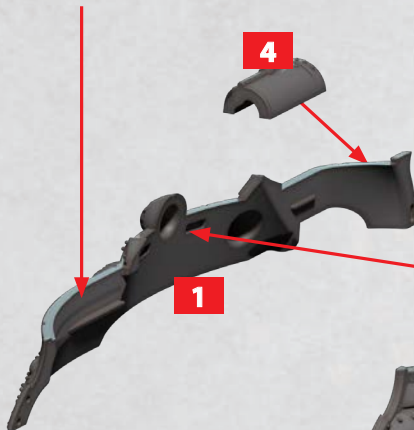

1



4

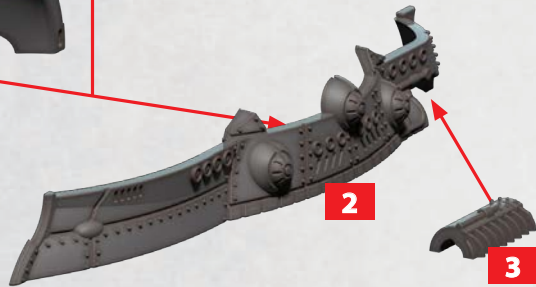

2



3





# ORIGEN CLASS LATHE SHIP

PARTS CAN BE FOUND ON THE ENLIGHTENED ADVANCED SQUADRONS SPRUES

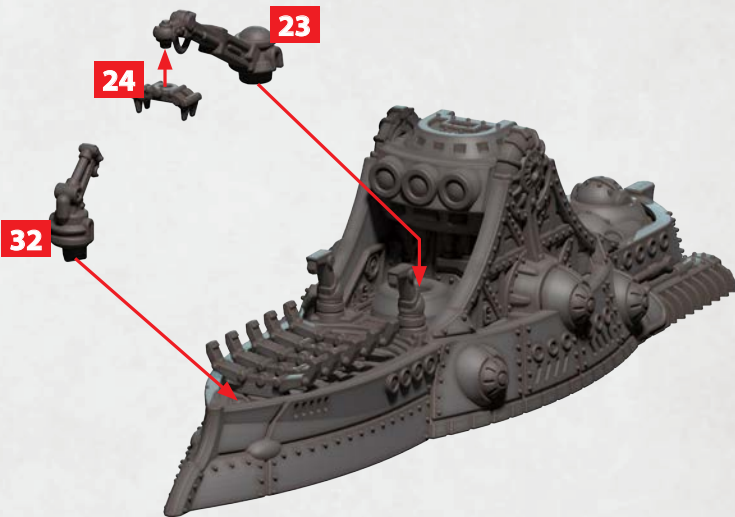
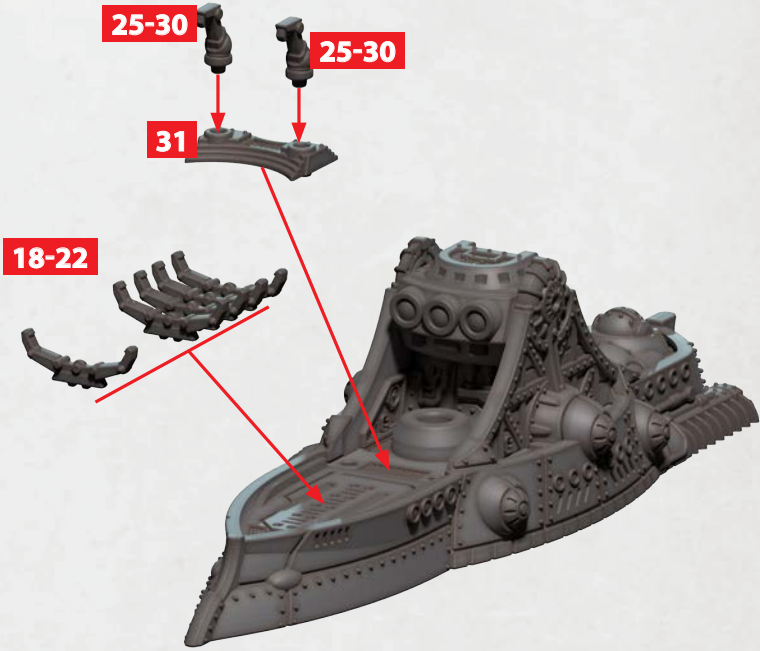



# NEWTON CLASS VOID-ENGINE CRUISER

PARTS CAN BE FOUND ON THE ENLIGHTENED ADVANCED SQUADRONS SPRUES

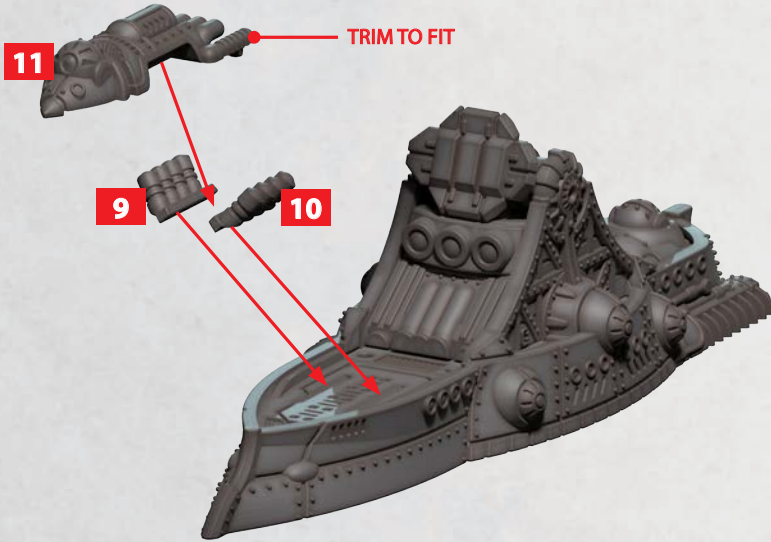

# VESALIUS CLASS CETACEAN SURGICAL SHIP

PARTS CAN BE FOUND ON THE ENLIGHTENED ADVANCED SQUADRONS SPRUES

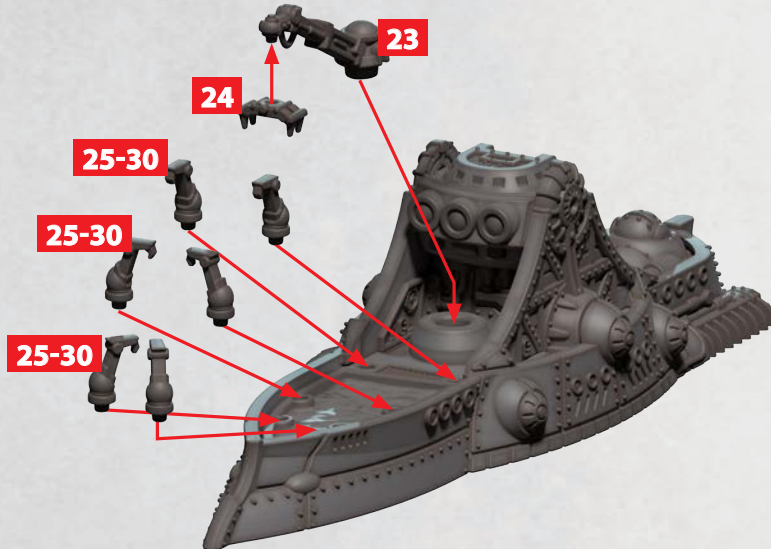



# ZUMEENA CLASS CAPACITOR SHIP

PARTS CAN BE FOUND ON THE ENLIGHTENED ADVANCED SQUADRONS SPRUES

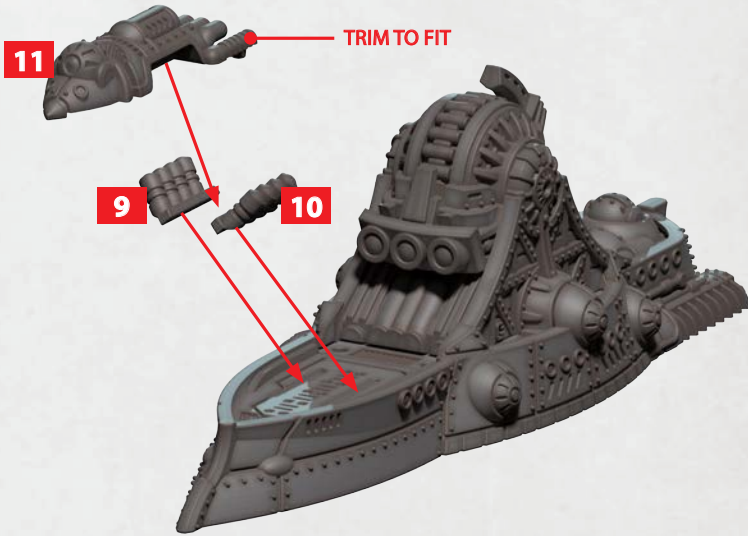

# SUPPORT SHIP HULL

PARTS CAN BE FOUND ON THE ENLIGHTENED SUPPORT SQUADRONS SPRUES

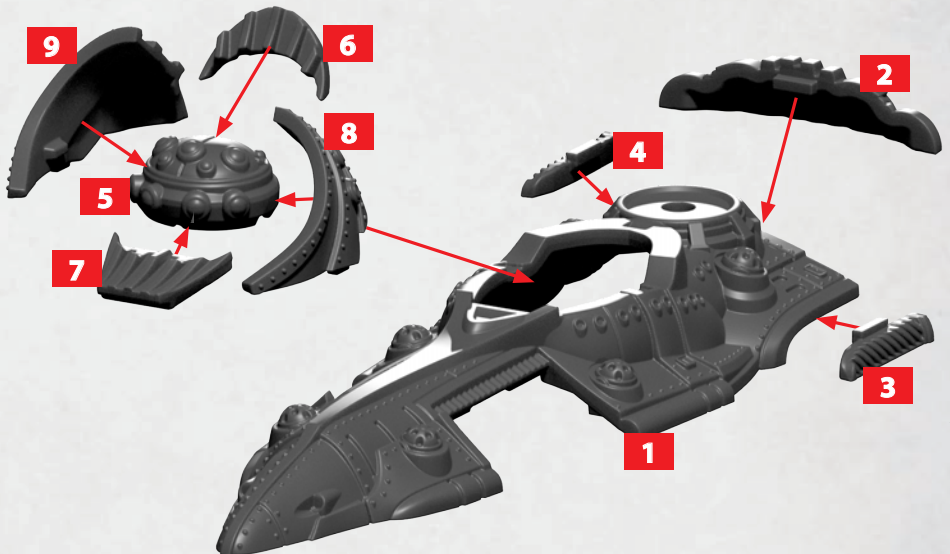



# PLINIUS CLASS SUPPORT CARRIER

PARTS CAN BE FOUND ON THE ENLIGHTENED SUPPORT SQUADRONS SPRUES

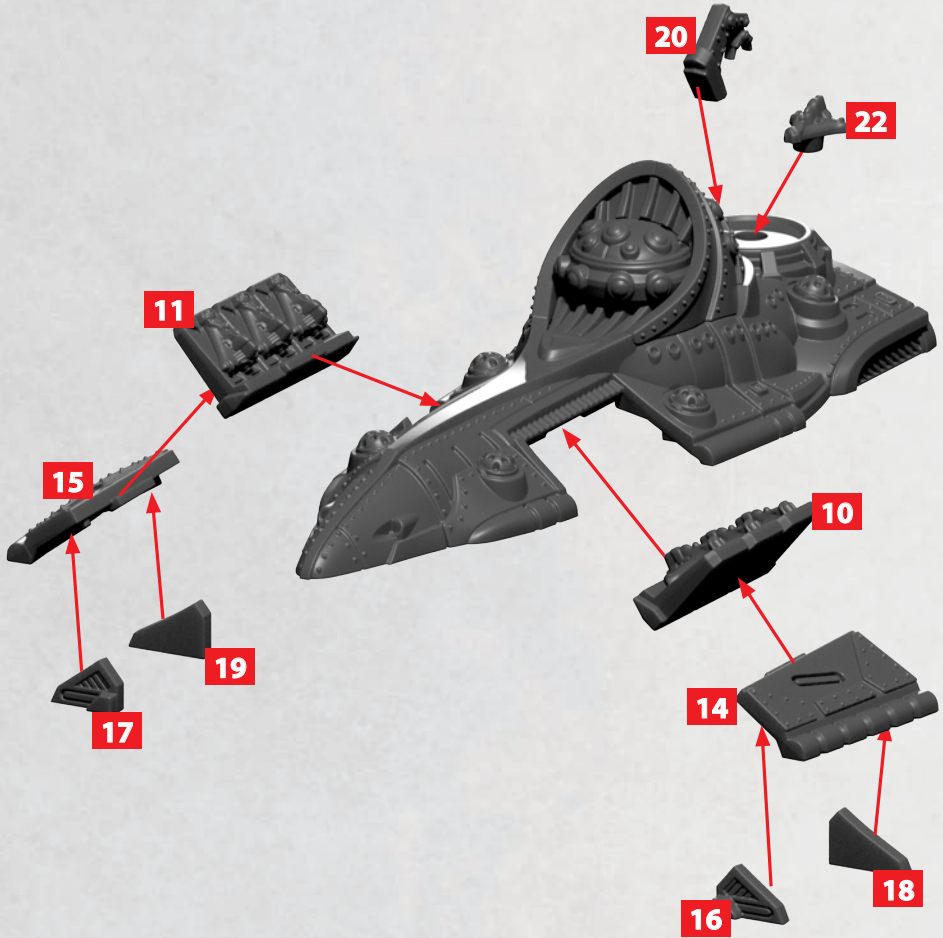



# QUINTILIAN CLASS BOMBARDMENT CRUISER

PARTS CAN BE FOUND ON THE ENLIGHTENED SUPPORT SQUADRONS SPRUES

- PLACE GENERATORS HERE. GENERATORS ARE FOUND ON THE ENLIGHTENED SUPPORT SPRUES, PARTS 45-51.

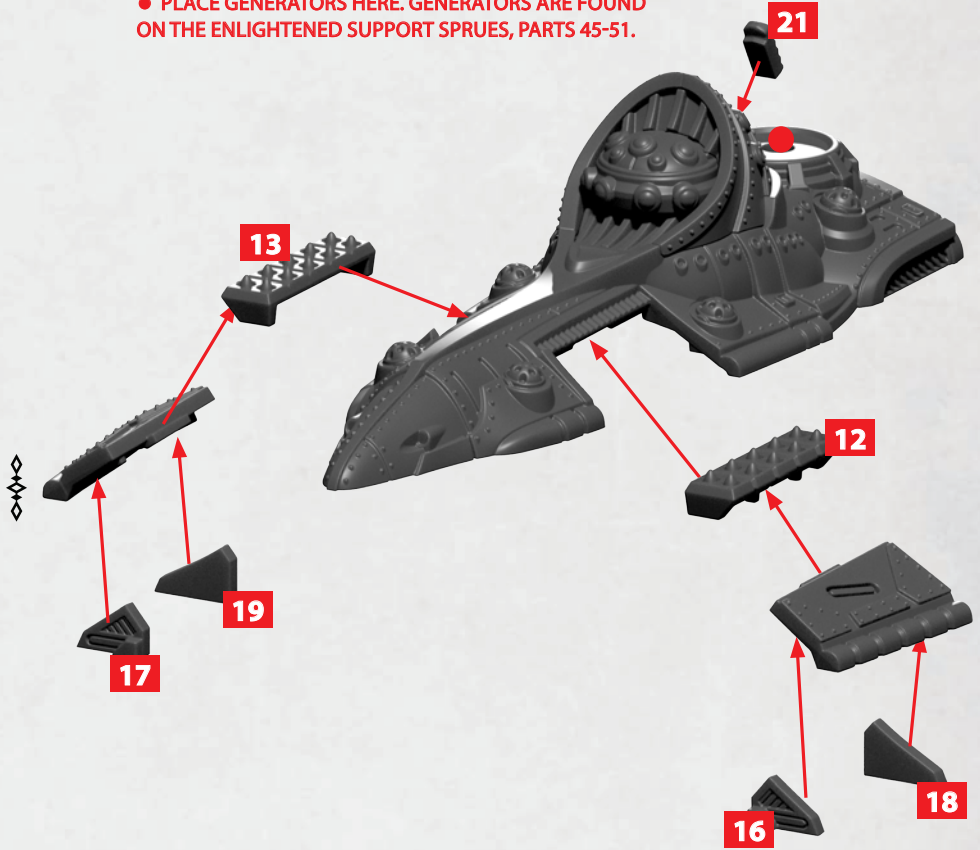



# CLAUDIUS CLASS MERCHANTMAN

PARTS CAN BE FOUND ON THE ENLIGHTENED SUPPORT SQRUES SPRUES

● PLACE GENERATORS HERE. GENERATORS ARE FOUND ON THE ENLIGHTENED SUPPORT SPRUES, PARTS 45-51.

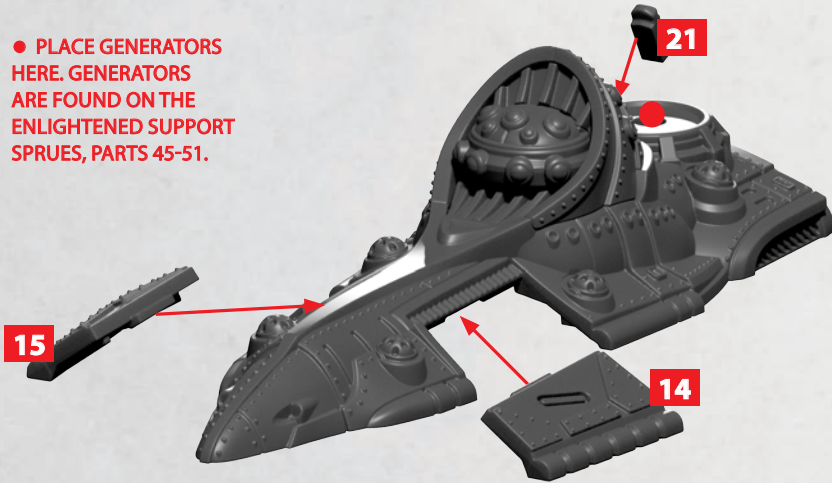

# TACITUS CLASS ASSAULT CRUISER

PARTS CAN BE FOUND ON THE ENLIGHTENED SUPPORT SQRUES SPRUES

● PLACE GENERATORS HERE. GENERATORS ARE FOUND ON THE ENLIGHTENED SUPPORT SPRUES, PARTS 45-51.

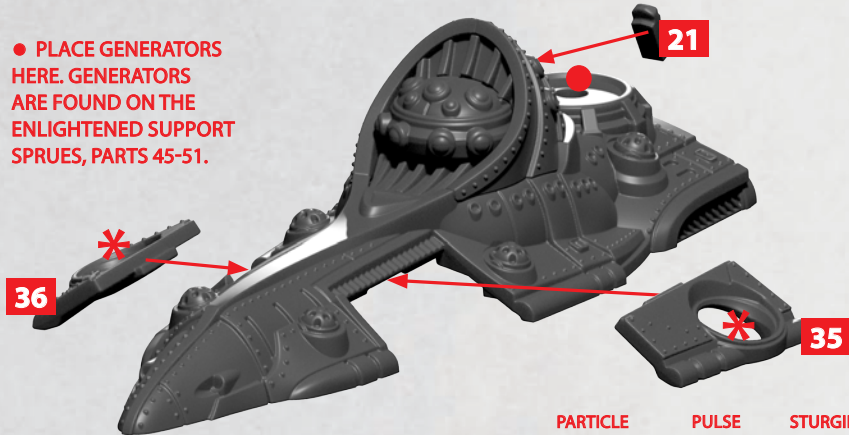

PARTICLE BEAMER



41-44

PULSE EMITTER



17-19

STURGINIUM AGITATOR



39-40

\* ALL TURRETS ARE INTERCHANGEABLE

PULSE EMITTER IS AVAILABLE ON THE ENLIGHTENED FRONTLINE SPRUE



# HULL FOR ANTARCTICA, LOVELACE OR ULYSSES CLASS SHIP

PARTS CAN BE FOUND ON THE ENLIGHTENED FRONTLINE SQUADRONS SPRUES

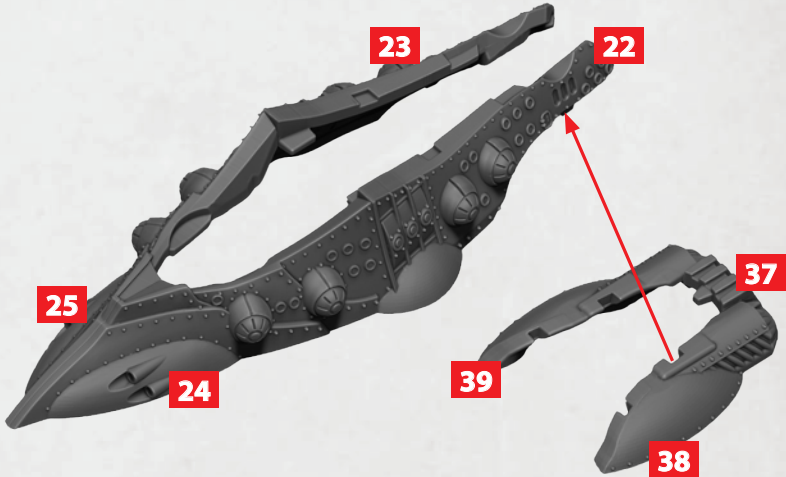



# HULL FOR ANTARCTICA, LOVELACE OR ULYSSES CLASS SHIP

PARTS CAN BE FOUND ON THE ENLIGHTENED FRONTLINE SQUADRONS SPRUES



PARTICLE BEAMER



10-16

PULSE EMITTER



17-19

STURGINIUM AGITATOR



39-40

\* ALL TURRETS ARE INTERCHANGEABLE

STURGINIUM AGITATOR IS AVAILABLE ON THE ENLIGHTENED SUPPORT SPRUE

# ANTARCTICA CLASS SUPERIORITY CRUISER

PARTS CAN BE FOUND ON THE ENLIGHTENED FRONTLINE SQUADRONS SPRUES







# ULYSSES CLASS VANGUARD CRUISER

PARTS CAN BE FOUND ON THE ENLIGHTENED FRONTLINE SQUADRONS SPRUES



# LOVELACE CLASS CRUISER

PARTS CAN BE FOUND ON THE ENLIGHTENED FRONTLINE SQUADRONS SPRUES





# HULL FOR COPERNICUS, CHATELET OR STILETTO CLASS SHIP

PARTS CAN BE FOUND ON THE ENLIGHTENED FRONTLINE SQUADRONS SPRUES

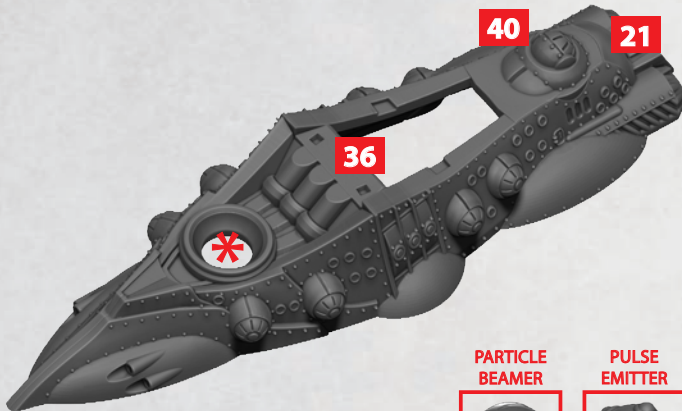
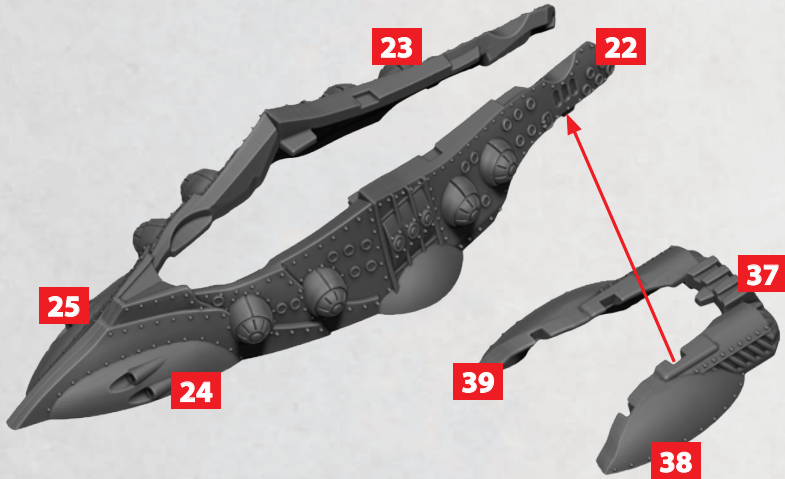

PARTICLE BEAMER



10-16

PULSE EMITTER



17-19

STURGINIUM AGITATOR



39-40

\* ALL TURRETS ARE INTERCHANGEABLE

STURGINIUM AGITATOR IS AVAILABLE ON THE ENLIGHTENED SUPPORT SPRUE



# HULL FOR COPERNICUS, CHATELET OR STILETTO CLASS SHIP

PARTS CAN BE FOUND ON THE ENLIGHTENED FRONTLINE SQUADRONS SPRUES



# COPERNICUS CLASS HEAVY CRUISER

PARTS CAN BE FOUND ON THE ENLIGHTENED FRONTLINE SQUADRONS SPRUES





# CHATALET CLASS RECON CRUISER

PARTS CAN BE FOUND ON THE ENLIGHTENED FRONTLINE SQUADRONS SPRUES



# STILETTO CLASS FAST CRUISER

PARTS CAN BE FOUND ON THE ENLIGHTENED FRONTLINE SQUADRONS SPRUES





# GERMAIN ZEBEK / MERIAN FRIGATE

PARTS CAN BE FOUND ON THE ENLIGHTENED FRONTLINE SQUADRONS SPRUES



TURRET FOR GERMAIN CLASS ZEBEK

10-16

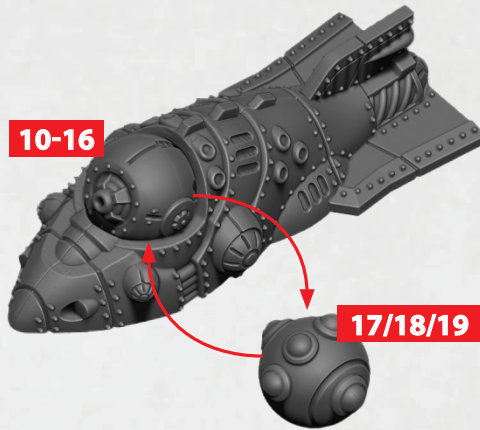

17/18/19

TURRET FOR MERIAN CLASS FRIGATE

PARTICLE BEAMER



10-16

PULSE EMITTER



17-19

\* ALL TURRETS ARE INTERCHANGEABLE



# DIOGENES CLASS TORPEDO SUBMARINE

PARTS CAN BE FOUND ON THE ENLIGHTENED SUPPORT SQUADRONS SPRUES

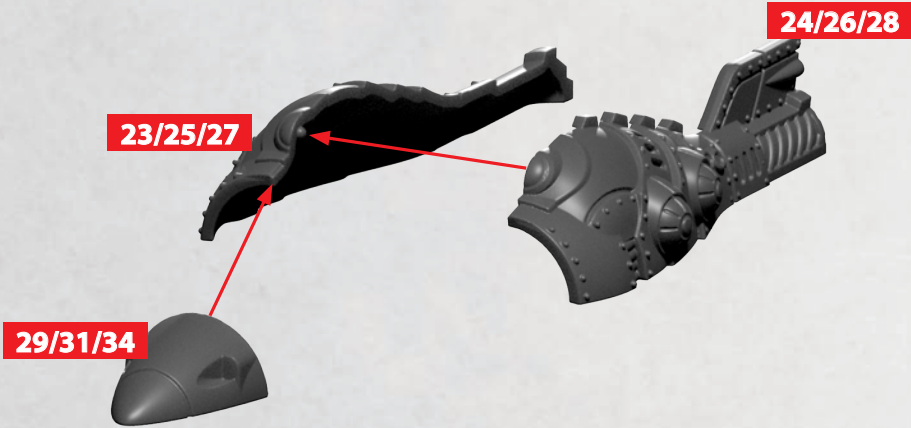

# PRAKILLA CLASS HUNTER SUBMARINE

PARTS CAN BE FOUND ON THE ENLIGHTENED SUPPORT SQUADRONS SPRUES

